



SPY II 39 M26L FOCUS CRI90 2700K MDL

12305431MD00-9027AB-070404-0000

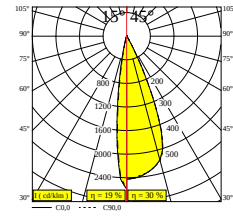
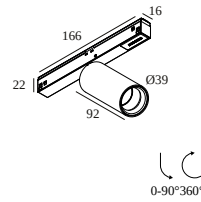
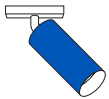

Image shows default finishes. Refer to the specifications below for the selected finishes per part.

Selected finishes per part



BODY



Brushed Anthracite
(07)

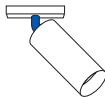

HINGE



Black (04)

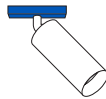

ADAPTER



Black (04)



[View on website](#)

General info

LOCATION	indoor
INSTALLATION	Low voltage systems Low voltage system mounted
INGRESS PROTECTION	IP20
WEIGHT (KG)	0.2
ADJUSTABILITY	0° to 90° swiveling, 360° rotatable

Electrical info

ELECTRICAL	48V-DC
CLASS	III
DIM TYPE	MDL = 1-10V or DALI or push button
ENERGY CLASS	F

Lightsource info

LIGHTSOURCE NAME	LED
LIGHTSOURCE	LED array 8,6W / CRI>90 (R9: 60) / 2700K / 974lm
TM-30 VALUES	rf: 89 / Rg: 100
SDCM	SDCM1
RISKGROUP	RG1
LM80	L90B10 > 50000
BEAMANGLE	15°-45°
LED TECHNICS (LIGHT SOURCE)	974lm // 8,6W // 113lm/W
LED TECHNICS (LUMINAIRE)	290lm // 9,9W // 29lm/W

DELTALIGHT

SPY II 39 M26L FOCUS CRI90 2700K MDL

12305431MD00-9027AB-070404-0000

COMPATIBLE COMPOSABLES

SHIFTLINE M26L profile (+ SHIFTLINE M26L MATRIX)

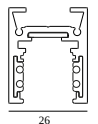

23358 0010 SLM26L - PROFILE 1m

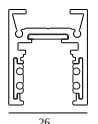

23358 0020 SLM26L - PROFILE 2m

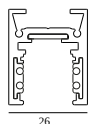

23358 0030 SLM26L - PROFILE 3m



Notes: