

# SPY 27 CLIP



Spy 27 is the smallest of the range and comes as a Clip mounted spotlight. Don't be fooled by its size, with a power of 5.8W it perfectly serves for general lighting in residential environments. For optimized visual comfort, a visor is available to reduce the glare when looking into the luminaire.

Specification	
LED Aperture:	1"
Ceiling Cut-out:	1 <sup>5</sup> / <sub>8</sub> "
Ceiling Thickness:	N/A
Adjustability:	Adjustable 0-85° / 355°
Rating:	IP20

Performance	
LED Maintenance:	L90>50,000h
McAdam Step:	1
CRI:	90
Wattage:	5.8W

Delivered Lumens:	2700K	3000K	3500K
Spy 27 S:	459Lm	480Lm	498Lm
Spy 27 L:	276Lm	288Lm	299 Lm

**Listing**

ETL certified to US and Canadian safety standards.

**Warranty**

5-year limited warranty.

## SPECIFICATION

ALL BOXES MUST BE FILLED IN TO CORRECTLY ORDER

Example: SPY27S-SP2730A-FBR-B-CLRS-IAT\_RMTD8-120

Luminaire	Size	Length	Power*	CCT	Optic	Function	Finish	Style	Installation	Applications	Controls***
SPY SPY	27 27mm/ 1" - 1/16 diameter	S Standard  L Long	SP Standard Power  30 3000K  35 3500K	27 2700K  30 30°	30 30°	A Adjustable	B-B Black-Black  FBR-B Flemish Bronze- Black  FG-B Flemish Gold- Black  GC-B Gold Colored- Black  W-W White-White	CL Slip Semi- Recessed	RS Surface time for rigid surface	IAT_RMT New Construction IC Airtight + Remote Power Supply  RMT Remote Power Supply	D1-UNV 0-10V dim 120-277V  D8-120 FE ELV dim 120V

\*\*\* Contact factory for additional dimming options

## Related Products

Spy 39, Spy 52, Spy 66, Spy 90, Spy Focus, Spy C (pendant)



## Finish Options

### SPY 27 S

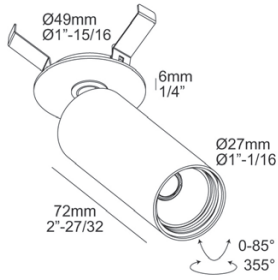

### SPY 27 L

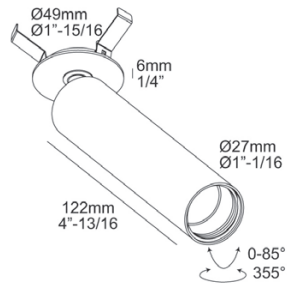

## Accessories



Visor 27  
24144 0040 B  
(Only used with Length S)

## Photometric Data

### SPY 27 S

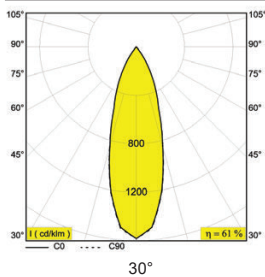

### SPY 27 L

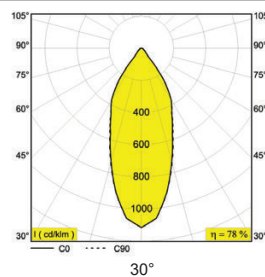



## Installation Options

### IC AIRTIGHT

**S-SMALL:**  
**A:**12"-5/8" x **B:**11"-1/16" x **C:**4"-13/16"  
**A:**323mm x **B:**281mm x **C:**122mm

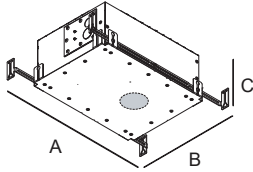

- Low Profile under 5" Height
- New Construction Airtight
- For use in insulated ceiling
- Chicago Plenum
- ETL Listed
- Hangerbar expand to 24"-23/32 or 15"-3/32 - reduce to 12"23/32 or 9"- 1/32
- Damp rated
- Patented System for easy driver service from room side

### REMOTE DRIVER (With Control D8)

**A:** 8" x **B:** 2"-1/2" x **C:** 2"-1/2"  
**A:** 203mm x **B:** 64mm x **C:** 64mm

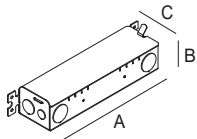

- For Remote application
- ETL Listed
- Damp rated

### REMOTE DRIVER (With Control D1)

**A:** 8" x **B:** 2"-3/16" x **C:** 4"-1/4"  
**A:** 203mm x **B:** 72mm x **C:** 108mm

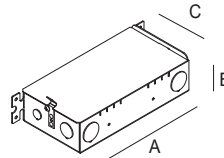

- For Remote application
- ETL Listed
- Damp rated

## Driver Options

### D1

- Dimming Control 0-10V
- Dimming Range 1-100%
- Dim to off yes at 0.8V, 1V, 1.2V, or N/A
- Power Factor @ Full Load >0.9 under 120Vac Input with 80~100% load condition (for all output currents)
- Efficiency @ Full Load ≥86
- THD @ Full Load <20% under 120Vac input with 80~100% load condition (for all output currents)

#### Dimmer Compatibility

- Leviton IP710-LFZ / IP710-DLX
- Lutron DTV/DVSTV/DVSCSTV/DVSCSTV

### D8

- Dimming Control Phase Control
- Dimming Range 10-100%
- Dim to off no
- Power Factor @ Full Load >0.9
- Efficiency @ Full Load ≥78
- THD @ Full Load <12%

#### Dimmer Compatibility

- Leviton IPE04-1LZ
- Lutron DVELV-300P

As technology changes, please use information above as guidance. For most recent updated information please contact factory. Specifications subject to change without notice.