

## OML50 CT - SPY 66 94018 DIM5

31152 9415 W

AVAILABLE IN  
**BLACK** 31152 9415 B  
**WHITE** 31152 9415 W

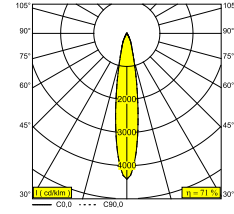
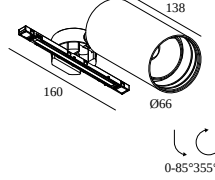

[View on website](#)



### General info

<b>LOCATION</b>	indoor
<b>INGRESS PROTECTION</b>	IP20
<b>WEIGHT (KG)</b>	0.5
<b>ADJUSTABILITY</b>	0° to 85° swiveling, 355° rotatable
<b>INFORMATION</b>	REFLECTOR SP-18° WHITE version: INCL.SPY 66 TUBE White all other versions: INCL.SPY 66 TUBE Black for OMNILINER TRACK mounting Optional REFLECTORS 30° & 45° available

### Electrical info

<b>ELECTRICAL</b>	48V-DC
<b>CLASS</b>	III
<b>DIM TYPE</b>	DALI
<b>ENERGY CLASS</b>	E
<b>CERTIFICATES</b>	CB, ENEC, LCA

### Lightsource info

<b>LIGHTSOURCE NAME</b>	LED
<b>LIGHTSOURCE</b>	LED array 25W / CRI>90 (R9: 79) / 4000K / 2974lm
<b>TM-30 VALUES</b>	rf: 90 / Rg: 99
<b>SDCM</b>	SDCM1
<b>RISKGROUP</b>	RG1
<b>LM80</b>	L90B10 > 50000
<b>BEAMANGLE</b>	18°
<b>LED TECHNICS (LIGHT SOURCE)</b>	2974lm // 25W // 119lm/W

### Options

SPY 66 TUBE

### Accessories

HONEYCOMB 57  
 SPREAD LENS 57  
 LINEAR SPREAD LENS 57  
 SOFTENING LENS 57  
 GLASS SBL 57

# DELTALIGHT

## OML50 CT - SPY 66 94018 DIM5

31152 9415 W

For detailed installation instructions, please consult the manual : [31152\\_XXX5\\_HAND.pdf](#)

### WHERE USED

<b>31951 9305</b>	OMNILINER 50 CT P1312 SBL HE 930 DIM5
<b>31951 9405</b>	OMNILINER 50 CT P1312 SBL HE 940 DIM5
<b>31952 9305</b>	OMNILINER 50 CT P1312 SBL HO 930 DIM5
<b>31952 9405</b>	OMNILINER 50 CT P1312 SBL HO 940 DIM5
<b>31953 9305</b>	OMNILINER 50 CT P1640 SBL HE 930 DIM5
<b>31953 9405</b>	OMNILINER 50 CT P1640 SBL HE 940 DIM5
<b>31954 9305</b>	OMNILINER 50 CT P1640 SBL HO 930 DIM5
<b>31954 9405</b>	OMNILINER 50 CT P1640 SBL HO 940 DIM5
<b>31955 9305</b>	OMNILINER 50 CT P1968 SBL HE 930 DIM5
<b>31955 9405</b>	OMNILINER 50 CT P1968 SBL HE 940 DIM5
<b>31956 9305</b>	OMNILINER 50 CT P1968 SBL HO 930 DIM5
<b>31956 9405</b>	OMNILINER 50 CT P1968 SBL HO 940 DIM5
<b>31957 9305</b>	OMNILINER 50 CT P2624 SBL HE 930 DIM5
<b>31957 9405</b>	OMNILINER 50 CT P2624 SBL HE 940 DIM5
<b>31958 9305</b>	OMNILINER 50 CT P2624 SBL HO 930 DIM5
<b>31958 9405</b>	OMNILINER 50 CT P2624 SBL HO 940 DIM5
<b>31961 9305</b>	OMNILINER 50 CT P1312 PRISMATIC LENS HE 930 DIM5
<b>31961 9405</b>	OMNILINER 50 CT P1312 PRISMATIC LENS HE 940 DIM5
<b>31962 9305</b>	OMNILINER 50 CT P1312 PRISMATIC LENS HO 930 DIM5
<b>31962 9405</b>	OMNILINER 50 CT P1312 PRISMATIC LENS HO 940 DIM5
<b>31963 9305</b>	OMNILINER 50 CT P1640 PRISMATIC LENS HE 930 DIM5
<b>31963 9405</b>	OMNILINER 50 CT P1640 PRISMATIC LENS HE 940 DIM5
<b>31964 9305</b>	OMNILINER 50 CT P1640 PRISMATIC LENS HO 930 DIM5
<b>31964 9405</b>	OMNILINER 50 CT P1640 PRISMATIC LENS HO 940 DIM5
<b>31965 9305</b>	OMNILINER 50 CT P1968 PRISMATIC LENS HE 930 DIM5
<b>31965 9405</b>	OMNILINER 50 CT P1968 PRISMATIC LENS HE 940 DIM5
<b>31966 9305</b>	OMNILINER 50 CT P1968 PRISMATIC LENS HO 930 DIM5
<b>31966 9405</b>	OMNILINER 50 CT P1968 PRISMATIC LENS HO 940 DIM5
<b>31967 9305</b>	OMNILINER 50 CT P2624 PRISMATIC LENS HE 930 DIM5
<b>31967 9405</b>	OMNILINER 50 CT P2624 PRISMATIC LENS HE 940 DIM5
<b>31968 9305</b>	OMNILINER 50 CT P2624 PRISMATIC LENS HO 930 DIM5
<b>31968 9405</b>	OMNILINER 50 CT P2624 PRISMATIC LENS HO 940 DIM5

Notes: