

# M-VIZIR / HEDRA



Hedra, a new member of the Delta Light family, add refinement, finesse and color to the range. They are characterized by an atypical hinge, a design element that not only catches the eye, but also serves as storage for technical parts inside the luminaire. The Hedra is available in the new Gold Colored anodization and Black Bronze finishes, with faceted texture. The faceted design of the Hedra captures and reflects the ambient light with an ever-changing look as result.

Specification	
LED Aperture:	1 <sup>27</sup> / <sub>32</sub> "
Adjustability:	Adjustable 0-90° / 355°
Rating:	IP20

Performance	8°	33°
LED Maintenance:	L90>41,000h	L90>50,000h
McAdam Step:	2	
CRI:	90	
*MP:	7W	12W

Delivered Lumens	2700K		3000K		3500K	
Optic:	SS	MD	SS	MD	SS	MD
M-Vizir/Hedra:	397Lm	544Lm	397Lm	566Lm	397Lm	584Lm

**Listing**

ETL certified to US and Canadian safety standards.

**Warranty**

5-year limited warranty.

**Ordering**

ALL BOXES MUST BE FILLED IN TO CORRECTLY ORDER

Example: HDRS-MPSS27A-BBR-B-M20H-MDL

Luminaire	Length	Power*	Optic	CCT	Function	Finish	Inner Finish	Application <sup>(1)</sup>	Controls	
<b>HDR</b> HEDRA (faceted)	<b>S</b> Standard	<b>MP</b> Medium Power	<b>SS</b> Super Spot 8°	<b>27</b> 2700K	<b>A</b> Adjustable	<b>BBR</b> Black Bronze	<b>B</b> Black	<b>M20H</b> Shiftline M26H / Shiftline M26H + SBL <sup>(2)</sup> / Splitline M20 / Splitline M20 ST Profile	<b>MDL</b> <sup>(2)</sup> 0-10V dim via Modulator	
<b>VZR</b> VIZIR (smooth)	<b>L</b> Long	<b>MP</b> Medium Power	<b>MD</b> Medium Spot 33°	<b>30</b> 3000K		<b>GC</b> Gold Colored	<b>FBR</b> Flemish Bronze			<b>ML</b> Shiftline M26L
				<b>35</b> 3500K		<b>FG</b> Flemish Gold	<b>W</b> White			

<sup>1</sup> Profile system hardware specified separately.  
<sup>2</sup> Shiftline M26H + SBL only available with Controls D5.

**Related Products**

M-Spy 27/39, M-Spy 52/66/Focus

**Finish Options**

**M-HEDRA S**

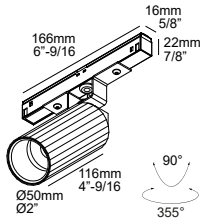

For Application M20H

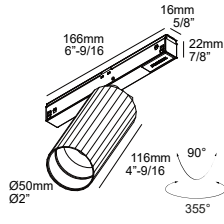

For Application ML



BLACK BRONZE  
(shown in Shiftline M26H)



GOLD COLORED  
(shown in Shiftline M26H)

**M-HEDRA L**

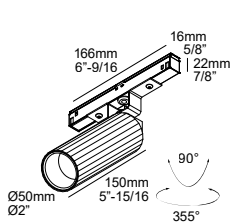

For Application M20H

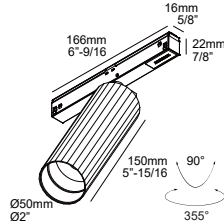

For Application ML



BLACK BRONZE  
(shown in Shiftline M26H)



GOLD COLORED  
(shown in Shiftline M26H)

**M-VIZIR S**

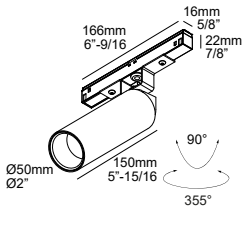

For Application M20H

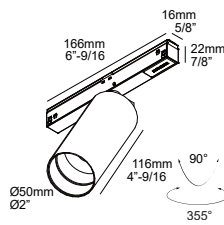

For Application ML



BLACK BRONZE  
(shown in Splitline M20)



GOLD COLORED  
(shown in Splitline M20)

**M-VIZIR L**

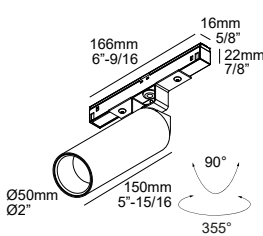

For Application M20H

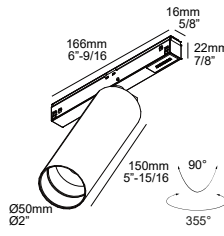

For Application ML



BLACK BRONZE  
(shown in Splitline M20)



GOLD COLORED  
(shown in Splitline M20)

**INNER FINISH**



BLACK



FLEMISH BRONZE



FLEMISH GOLD



WHITE

Accessories



HONEYCOMB  
473 03 01 B

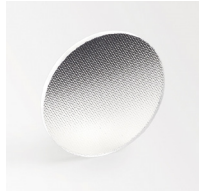

SOFTENING LENS  
473 03 04

Photometric Data

VIZIR / HEDRA

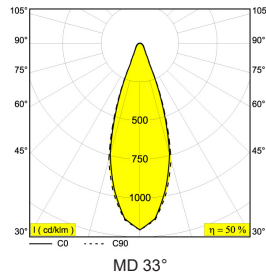
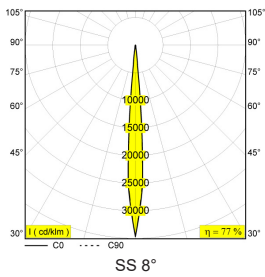

Installation Options

Delta Light's Magnetic Systems all utilize 48V remote power supplies. With a maximum of 96W per power supply, the below details maximum magnetic modules per power feed.

Maximum Capacity per Remote Power Supply	SS	MD
*MP:	13	7

FOR SYSTEM HARDWARE, REFER TO THE FOLLOWING PROFILE SYSTEMS:  
 Shiftline M26H (surface/suspended, high-height, optional curved corner connectors)  
 Shiftline M26H + SBL (surface/suspended, high-height, integral continuous light line)  
 Shiftline M26L (surface/suspended, low-height, stacking possible)  
 Splitline M20 (recessed, knife-edge, optional curved corner connectors)  
 Splitline M20 ST (recessed, small trim)

As technology changes, please use information above as guidance. For most recent updated information please contact factory. Specifications subject to change without notice.