

OML50 CT - SPY 66 93030 DIM5

31152 9325 W

AVAILABLE IN
BLACK 31152 9325 B
WHITE 31152 9325 W

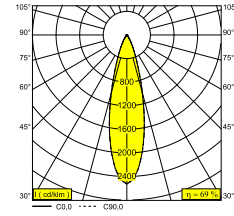
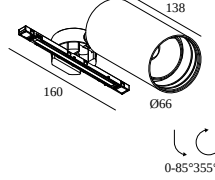

[View on website](#)



General info

LOCATION	indoor
INGRESS PROTECTION	IP20
WEIGHT (KG)	0.5
ADJUSTABILITY	0° to 85° swiveling, 355° rotatable
INFORMATION	REFLECTOR FL-30° WHITE version: INCL.SPY 66 TUBE White all other versions: INCL.SPY 66 TUBE Black for OMNILINER TRACK mounting Optional REFLECTORS 18° & 45° available

Electrical info

ELECTRICAL	48V-DC
CLASS	III
DIM TYPE	DALI
ENERGY CLASS	F
CERTIFICATES	CB, ENEC, LCA

Lightsource info

LIGHTSOURCE NAME	LED
LIGHTSOURCE	LED array 25W / CRI>90 (R9: 52) / 3000K / 2811lm
TM-30 VALUES	rf: 90 / Rg: 99
SDCM	SDCM1
RISKGROUP	RG1
LM80	L90B10 > 50000
BEAMANGLE	30°
LED TECHNICS (LIGHT SOURCE)	2811lm // 25W // 112lm/W

Options

SPY 66 TUBE

Accessories

HONEYCOMB 57
 SPREAD LENS 57
 LINEAR SPREAD LENS 57
 SOFTENING LENS 57
 GLASS SBL 57

DELTALIGHT

OML50 CT - SPY 66 93030 DIM5

31152 9325 W

For detailed installation instructions, please consult the manual : [31152_XXX5_HAND.pdf](#)

WHERE USED

31951 9305	OMNILINER 50 CT P1312 SBL HE 930 DIM5
31951 9405	OMNILINER 50 CT P1312 SBL HE 940 DIM5
31952 9305	OMNILINER 50 CT P1312 SBL HO 930 DIM5
31952 9405	OMNILINER 50 CT P1312 SBL HO 940 DIM5
31953 9305	OMNILINER 50 CT P1640 SBL HE 930 DIM5
31953 9405	OMNILINER 50 CT P1640 SBL HE 940 DIM5
31954 9305	OMNILINER 50 CT P1640 SBL HO 930 DIM5
31954 9405	OMNILINER 50 CT P1640 SBL HO 940 DIM5
31955 9305	OMNILINER 50 CT P1968 SBL HE 930 DIM5
31955 9405	OMNILINER 50 CT P1968 SBL HE 940 DIM5
31956 9305	OMNILINER 50 CT P1968 SBL HO 930 DIM5
31956 9405	OMNILINER 50 CT P1968 SBL HO 940 DIM5
31957 9305	OMNILINER 50 CT P2624 SBL HE 930 DIM5
31957 9405	OMNILINER 50 CT P2624 SBL HE 940 DIM5
31958 9305	OMNILINER 50 CT P2624 SBL HO 930 DIM5
31958 9405	OMNILINER 50 CT P2624 SBL HO 940 DIM5
31961 9305	OMNILINER 50 CT P1312 PRISMATIC LENS HE 930 DIM5
31961 9405	OMNILINER 50 CT P1312 PRISMATIC LENS HE 940 DIM5
31962 9305	OMNILINER 50 CT P1312 PRISMATIC LENS HO 930 DIM5
31962 9405	OMNILINER 50 CT P1312 PRISMATIC LENS HO 940 DIM5
31963 9305	OMNILINER 50 CT P1640 PRISMATIC LENS HE 930 DIM5
31963 9405	OMNILINER 50 CT P1640 PRISMATIC LENS HE 940 DIM5
31964 9305	OMNILINER 50 CT P1640 PRISMATIC LENS HO 930 DIM5
31964 9405	OMNILINER 50 CT P1640 PRISMATIC LENS HO 940 DIM5
31965 9305	OMNILINER 50 CT P1968 PRISMATIC LENS HE 930 DIM5
31965 9405	OMNILINER 50 CT P1968 PRISMATIC LENS HE 940 DIM5
31966 9305	OMNILINER 50 CT P1968 PRISMATIC LENS HO 930 DIM5
31966 9405	OMNILINER 50 CT P1968 PRISMATIC LENS HO 940 DIM5
31967 9305	OMNILINER 50 CT P2624 PRISMATIC LENS HE 930 DIM5
31967 9405	OMNILINER 50 CT P2624 PRISMATIC LENS HE 940 DIM5
31968 9305	OMNILINER 50 CT P2624 PRISMATIC LENS HO 930 DIM5
31968 9405	OMNILINER 50 CT P2624 PRISMATIC LENS HO 940 DIM5

Notes: