

OML50 CT - SPY 66 93030 DIM5

31152 9325 B

ERHÄLTlich IN
SCHWARZ 31152 9325 B
WEISS 31152 9325 W

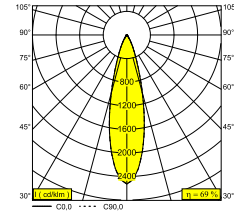
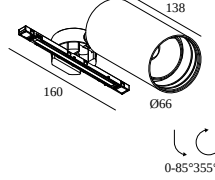

 [Auf der Website anzeigen](#)



Allgemeine Information

ANWENDUNGSBEREICH	innenbereich
SCHUTZ GEGEN EINDRINGEN	IP20
GEWICHT (KG)	0.5
VERSTELLBARKEIT	0° to 85° schwenkbar, 355° drehbar
INFORMATION	REFLECTOR FL-30° WHITE version: INCL.SPY 66 TUBE White all other versions: INCL.SPY 66 TUBE Black for OMNILINER TRACK mounting Optional REFLECTORS 18° & 45° available

Elektrische Informationen

ELEKTRISCH	48V-DC
KLASSE	III
ART DER DIMMUNG	DALI
ENERGIEKLASSE	F
ZERTIFIKATE	CB, ENEC, LCA

Lichtquelle Info

LIGHTSOURCE NAME	LED
LICHTQUELLE	LED array 25W / CRI>90 (R9: 52) / 3000K / 2811lm
TM-30	rf: 90 / Rg: 99
SDCM	SDCM1
RISIKOGRUPPE	RG1
LM80	L90B10 > 50000
BEAMANGLE	30°
LED -TECHNIK (LICHTQUELLE)	2811lm // 25W // 112lm/W

Optionen

SPY 66 TUBE

Zubehör

- HONEYCOMB 57
- SPREAD LENS 57
- LINEAR SPREAD LENS 57
- SOFTENING LENS 57
- GLASS SBL 57

DELTALIGHT

OML50 CT - SPY 66 93030 DIM5

31152 9325 B

Detaillierte Installationsanweisungen finden Sie in der Montageanleitung : [31152_XXX5_HAND.pdf](#)

WO VERWENDET

31951 9305	OMNILINER 50 CT P1312 SBL HE 930 DIM5
31951 9405	OMNILINER 50 CT P1312 SBL HE 940 DIM5
31952 9305	OMNILINER 50 CT P1312 SBL HO 930 DIM5
31952 9405	OMNILINER 50 CT P1312 SBL HO 940 DIM5
31953 9305	OMNILINER 50 CT P1640 SBL HE 930 DIM5
31953 9405	OMNILINER 50 CT P1640 SBL HE 940 DIM5
31954 9305	OMNILINER 50 CT P1640 SBL HO 930 DIM5
31954 9405	OMNILINER 50 CT P1640 SBL HO 940 DIM5
31955 9305	OMNILINER 50 CT P1968 SBL HE 930 DIM5
31955 9405	OMNILINER 50 CT P1968 SBL HE 940 DIM5
31956 9305	OMNILINER 50 CT P1968 SBL HO 930 DIM5
31956 9405	OMNILINER 50 CT P1968 SBL HO 940 DIM5
31957 9305	OMNILINER 50 CT P2624 SBL HE 930 DIM5
31957 9405	OMNILINER 50 CT P2624 SBL HE 940 DIM5
31958 9305	OMNILINER 50 CT P2624 SBL HO 930 DIM5
31958 9405	OMNILINER 50 CT P2624 SBL HO 940 DIM5
31961 9305	OMNILINER 50 CT P1312 PRISMATIC LENS HE 930 DIM5
31961 9405	OMNILINER 50 CT P1312 PRISMATIC LENS HE 940 DIM5
31962 9305	OMNILINER 50 CT P1312 PRISMATIC LENS HO 930 DIM5
31962 9405	OMNILINER 50 CT P1312 PRISMATIC LENS HO 940 DIM5
31963 9305	OMNILINER 50 CT P1640 PRISMATIC LENS HE 930 DIM5
31963 9405	OMNILINER 50 CT P1640 PRISMATIC LENS HE 940 DIM5
31964 9305	OMNILINER 50 CT P1640 PRISMATIC LENS HO 930 DIM5
31964 9405	OMNILINER 50 CT P1640 PRISMATIC LENS HO 940 DIM5
31965 9305	OMNILINER 50 CT P1968 PRISMATIC LENS HE 930 DIM5
31965 9405	OMNILINER 50 CT P1968 PRISMATIC LENS HE 940 DIM5
31966 9305	OMNILINER 50 CT P1968 PRISMATIC LENS HO 930 DIM5
31966 9405	OMNILINER 50 CT P1968 PRISMATIC LENS HO 940 DIM5
31967 9305	OMNILINER 50 CT P2624 PRISMATIC LENS HE 930 DIM5
31967 9405	OMNILINER 50 CT P2624 PRISMATIC LENS HE 940 DIM5
31968 9305	OMNILINER 50 CT P2624 PRISMATIC LENS HO 930 DIM5
31968 9405	OMNILINER 50 CT P2624 PRISMATIC LENS HO 940 DIM5

Notes: