

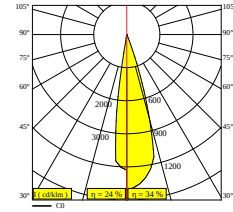

M26L - SPY 39 FRAMER 927 DIM5

23432 9205 B

AVAILABLE IN
BLACK 23432 9205 B

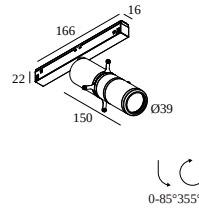

 [View on website](#)



General info

LOCATION	indoor
INSTALLATION	Low voltage systems Low voltage system mounted
INGRESS PROTECTION	IP20
WEIGHT (KG)	0.3
ADJUSTABILITY	0° to 85° swiveling, 360° rotatable
INFORMATION	EXCL.LED POWER SUPPLY 48V-DC

Electrical info

ELECTRICAL	48V-DC
CLASS	III
DIM TYPE	DALI
ENERGY CLASS	F

Lightsource info

LIGHTSOURCE NAME	LED
LIGHTSOURCE	LED array 8,6W / CRI>90 (R9: 60) / 2700K / 974lm
TM-30 VALUES	rf: 89 / Rg: 100
SDCM	SDCM1
RISKGROUP	RG1
LM80	L90B10 > 50000
LED TECHNICS (LIGHT SOURCE)	974lm // 8,6W // 113lm/W
LED TECHNICS (LUMINAIRE)	332lm // 9,9W // 34lm/W

Requirements

LED POWER SUPPLY 48V-DC

For detailed installation instructions, please consult the manual : [23432_XXX5_HAND.pdf](#)

DELTALIGHT

M26L - SPY 39 FRAMER 927 DIM5

23432 9205 B

FINISH YOUR SPECIFICATION

LED power supplies

of Fixtures



of fixtures indicates how many devices can be connected (min -> max) to the power supply. The values before and after the '|' correspond respectively with the minimum and maximum driving current. Values between brackets are applicable to 110V.

Min current | Max current



300 89 48 100 LED POWER SUPPLY 48V-DC / 100W DIN

10

Dimtype: non-dimmable



300 89 48 240 LED POWER SUPPLY 48V-DC / 240W DIN

24

Dimtype: non-dimmable



21012 0230 LED POWER SUPPLY 48V-DC / 100W

10

Dimtype: non-dimmable

Cutout dimension (mm): 40



21012 0240 LED POWER SUPPLY 48V-DC / 200W

20

Dimtype: non-dimmable

Cutout dimension (mm): 40

COMPATIBLE COMPOSABLES

SHIFTLINE M26L profile (+ SHIFTLINE M26L MATRIX)

Available Colours

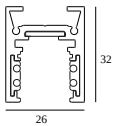

23358 0000 SLM26L - PROFILE

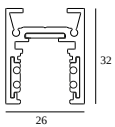

23358 0010 SLM26L - PROFILE 1m

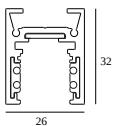

23358 0020 SLM26L - PROFILE 2m



DELTALIGHT

M26L - SPY 39 FRAMER 927 DIM5

23432 9205 B



23358 0030 SLM26L - PROFILE 3m



Notes: